

# DC Motor · 1627N5M- · $\varnothing$ 16 mm

**Specifications** Please consult your authorized sales representative for custom specifications.

Type			101-4.5-001	100-6.0-001	102-12.0-001
Rated voltage	U	V	4.5	6	12
Terminal resistance	R	Ohm	1.5	2	8.5
No load speed	$n_0$	rpm	10100	10000	10200
No load current	$I_0$	mA	45	45	35
Stall torque	$T_s$	mNm	12.4	16.7	15.1
Rated torque	T	mNm	2.5	3.5	3.5
Rated speed	n	rpm	6100	7500	7200
Rated current	I	mA	650	670	360
Power	$P_{max.}$	W	3.38	4.5	4.24
Max. efficiency	$\eta$	%	72	76	70
Back-EMF constant	$K_E$	mV/rpm	0.44	0.59	1.15
Torque constant	$K_T$	mNm/A	4.19	5.65	10.96
Rotor inertia	$J_{Rotor}$	gcm <sup>2</sup>	0.8	0.8	1
Speed regulation constant	$\Delta n / \Delta T$	rpm/mNm	871	872	675
Weight		g	24	24	24
Length	L	mm	26.6	26.6	26.6
<b>Operational conditions*</b>					
Temperature range	T	°C	-20 ~ +65		
Axial force dynamic	$F_{Adyn}$	N	0.5		
Axial force static	$F_{St}$	N	20		
Radial force at 3 mm from mounting face	$F_R$	N	1		

\* at 25° C

Commutator	metal 5 segments
Max. winding temperature	120 °C
Protection class	IP 20
RFI Protection	Varistor
Bearings	2 sintered bronze

**Optional:**  
with dual axial output

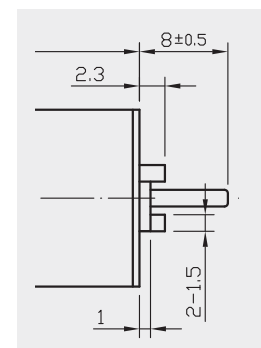

## Dimension (mm) · 1627N5M:

